

PART #	DESCRIPTION	QTY	PART #	DESCRIPTION	QTY	PART #	DESCRIPTION	QTY
VC5134	CHAIN GUARD REAR	1	VH0321	NUT, NYLOCK, 1/4 - 20, HEAVY DUTY	10	VH0910	GEARHEAD - DRIVE CHAIN	1
VC5135	CHAIN GUARD RIGHT	1	VH0332	SHCS, 1/4 - 20 x 2 3/4	2	VH0911	DRIVE MOTOR	1
VC5136	CHAIN GUARD FRONT	1	VH0355	MUFFLER, 1/8	1	VH0987	SHCS, M6 x 20mm	4
VC5138	SAFETY PANEL BACK	1	VH0362	MAC VALVE, 115V AC	1	VH0996	WASHER, FENDER, #10, 1 OD	26
VC5139	SAFETY PANEL BACK RIGHT PORTION	1	VH0367	PUSH-IN FTG, 90, 1/2 OD x 1/2 NPT	1	VH0997	10 X 3/4 SELF DRILLING SCREW	26
VC5140	CHAIN GUARD LEFT SIDE	1	VH0373	CABLE - EXIT CONVEYOR	1			
VC5141	ANGLE BRACE, SAFETY PANEL BACK	4	VH0386	SAFETY VALVE	1			
VC5142	STANDOFF SAFETY PANEL BACK	4	VH0402	SHCS, 5/16 - 18 x 5/8	10			
			VH0403	SHCS, 3/8 - 24 x 2	4			
VC5163	TOOL POST LONG ASS'Y	1	VH0487	SHCS, 3/8 - 16 x 3	1			
VC5224	MODEL AND SERIAL NUMBER TAG	1	VH0580	FHCS, M8 x 25mm	4			
VC5238	AIR TANK	1	VH0582	CYLINDER, BIMBA	2			
VC5247	SPACER - EXTENSION PLATE	2	VH0613	SHCS, 3/8 - 16 x 1 1/4	2			
VC5248	EXTENSION PLATE	1	VH0620	HHCS, 5/16 - 18 x 3/4, FULL THD	2			
VC5252	MOTOR MOUNT	1	VH0694	WASHER, SAE, 3/8	9			
VC5253	RISER	3	VH0740	WASHER, LOCK, 3/8	6			
VC5256	LEG ASSEMBLY	1	VH0838	SHCS, 3/8 - 16 x 3 1/4	1			

VC5257	FRONT CHAIN SUPPORT RAIL	1
VC5258	CHAIN SUPPORT RAIL	1
VC5260	IDLER SPROCKET RACE	1
VC5265	REAR CHAIN SUPPORT RAIL	1
VC5267	REAR FENCE	1
VC5282	FRONT RAIL - AUTOMATIC	1
VC5283	REAR RAIL - AUTOMATIC	1
VC5284	STRUT	1
VC5286	FENCE TRACK	1
VC5288	EXIT GUIDE PLATE	1
VC5290	DRIVE CHAIN	1
VC5292	IDLER SPROCKET W/ FLANGED BEARINGS	1
VC5417	CONTROL VALVE DETAIL	1
VC5422	3100 CONTROL BOX STAND	1
VC5425	ELECTRICAL CONTROL BOX ASSY	1
VC5427	CONTROL BOX BRACKET	2
VC5436	STRUT - 3100	1
VC5438	BACK FENCE BRACE	1
VC5529	DISPENSER FRAME ASSY	1
VC5550	BHCS FOR BLANK LUG VC5860	12
VC5558	RAIL TRIGGER SWITCH DETAIL - SERVO	1
VC5571	FRONT FENCE DETAIL	1
VC5574	LUG ASSEMBLY (UNIVERSAL)	3
VC5576	U-BOLT	2
VC5579	TOP GUARD	1
VC5580	BOTTOM GUARD	1
VC5581	SPROCKET SPACER	1
VC5590	SPROCKET UPTAKE ASSEMBLY - 3100	1
VC5595	SPROCKET SPACER - 3100	1
VC5598	TOOL HEIGHT MOTOR DETAIL - 3100	1
VC5731	REAR FENCE TAPE MEASURE	1
VC5736	EXIT CONVEYOR DETAIL	1
VC5749	TOOL ASSEMBLY	1
VC5758	LEG ASSEMBLY	1
VC5759	FENCE TRACK EXTENSION	1
VC5784	SPACER FOR FENCE EXTENSION	1
VC5785	MOUNT FOR TRACK EXTENSION	1
VC5846	CHAIN GUARD EXTENDER	1
VC5853	DRIVE SPROCKET	1
VC5855	MOTOR MOUNT BRACKET - SERVO MOTOR	1
VC5856	MOTOR MOUNT - SERVO	1
VC5857	SPACER - JOYSTICK/CYLINDER	2
VC5858	THREADED ROD - JOYSTICK CYLINDER	2
VC5860	CHAIN RAIL SUPPORT	6
VC5861	RAIL SPOOL STOP	1
VH0051	SHCS, 10 - 32 x 1/2	2
VH0060	SHCS, 5/16 - 18 x 3/4	14
VH0062	NUT, HEX, 5/16 - 18	8
VH0069	PUSH-IN FTG, 90, 1/4 OD x 1/8 NPT	3
VH0083	WASHER, HI-COLLAR, #10	2
VH0096	NUT, HEX, 3/8 - 16	4
VH0118	SHCS, 10 - 32 x 5/8	4
VH0120	WASHER, LOCK, 5/16	22
VH0144	SHCS, 10 - 32 x 1	2
VH0152	FHCS, 1/4 - 20 x 1/2	16
VH0183	SHCS, 3/8 - 16 x 3/4	6
VH0198	FHCS, 1/4 - 20 x 3/4	10
VH0201	PUSH-IN FTG, STR, 1/4 OD x 1/4 NPT	2
VH0216	NUT, NYLOCK, 10 - 32	6
VH0234	NUT, NYLOCK, 3/8 - 16	1
VH0238	DRIVE SCREW	4
VH0258	WASHER, THICK - 1/8, 5/16	2
VH0259	WASHER, THICK, 3/8	10
VH0261	SET SCREW, 3/8 - 16 x 1	1
VH0314	HHCS, 3/8 - 16 x 5/8, FULL THD	10
VH0315	SHCS, 1/4 - 20 x 3	4
VH0316	SHCS, 1/4 - 20 x 3/4	12
VH0317	SHCS, 3/8 - 16 x 1	1
VH0318	SHCS, 3/8 - 16 x 4	2

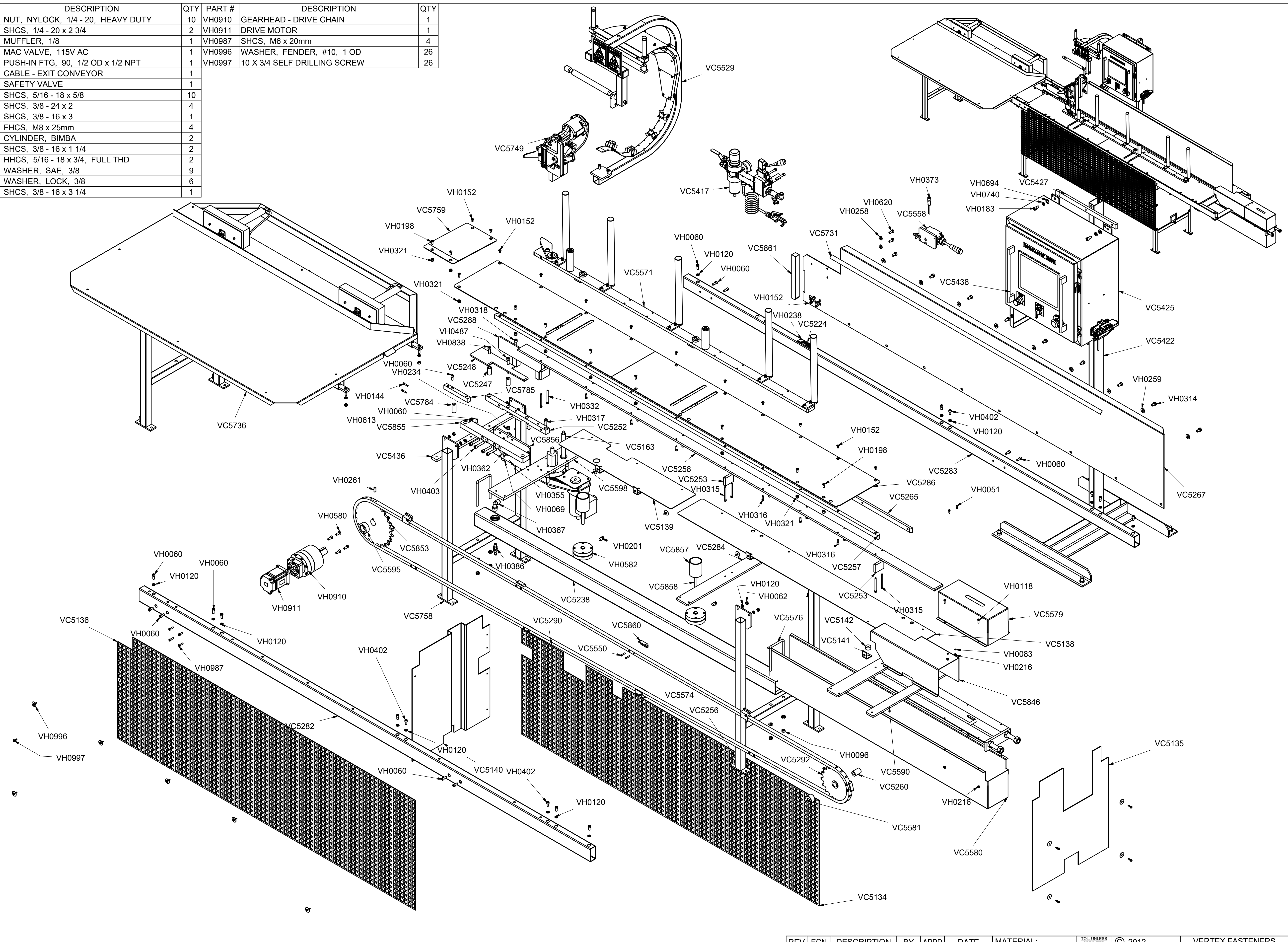

1798 Sherwin Avenue
Des Plaines, IL 60018 U.S.A.
EMAIL: vertex@leggett.com
PHONE: 847-768-6139 FAX: 847-768-7192

REV	ECN	DESCRIPTION	BY	APPD	DATE	MATERIAL:	TOL UNLESS SPECIFIED	© 2012	VERTEX FASTENERS
A	131118	ADD VC5738, VC5438	RP	JMW	11/18/13		INCHES XX = ±.005 XXX = ±.005 ANGLES ±1/2	DWN BY JMW	1798 SHERWIN AVENUE DES PLAINES, IL 60018 U.S.A.
B	150428	REVISED COMPONENTS	RP	MR	4/28/15	HEAT TREATMENT:		APPD RP	
C	151008	REMOVED VH0281, VH0283, VH0285	RP	MR	10/5/15			DATE 9-10-12	VERSACLIPPER 3100 ASSEMBLY
D	160510	REVISED COMPONENTS	RP	MR	5/10/16	FINISH:		SCALE 1:8	
								DWG. NO. VC5015 / VA0424	D

THIS DOCUMENT AND THE DATA DISCLOSED HEREIN OR HEREWITH IS NOT TO BE REPRODUCED, USED, OR DISCLOSED IN WHOLE OR IN PART TO ANYONE WITHOUT THE PERMISSION OF VERTEX FASTENERS.