

PART #	DESCRIPTION	QT
VC8100	HOUSING	1
VC8102	SPRING, LATCH	1
VC8103	DEFLECTOR	1
VC8104	ROLLER	4
VC8105	SPOOL	1
VC8106	TRIGGER	1
VC8107	BUSHING, JAW	2
VC8108	PLATE	1
VC8109	CONSTANT FORCE SPRING	1
VC8111	VALVE ROD	1
VC8116	GUARD, TRIGGER	1
VC8117	SHIM, MAGAZINE, .010	AR
VC8119	RAIL, FEEDER GUIDE	1
VC8122	PISTON	1
VC8123	SIDE PLATE	2
VC8125	ROD, PISTON	1
VC8127	BRACKET, SPRING SPOOL	1
VC8131	LABEL, WARNING	1
VC8143	MAGAZINE, 1/2"	1
VC8144	JAW, UPPER, 1/2" RING	1
VC8145	JAW, LOWER, 1/2" RING	1
VC8146	BLADE, FEEDER, 1/2" RING	1
VC8147	FEEDER BLADE SHIM, 1/2" RING	1
VC8150	SPRING, 1/2" RING	1
VC8152	PUSHER, 1/2" RING	1
VC8153	SHOE, 1/2" RING	1
VC8156	LATCH, 1/2"	1
VC9124	LABEL	2
VH0005	O-RING, #016	-
VH0032	SHCS, 10 - 24 x 1	2
VH0033	BHCS, 10 - 32 x 1/4	2
VH0221	WASHER, 1/4	2
VH0459	PIN, SLOTTED SPRING, 3/32 x 3/8	2
VH0462	O-RING, #008	-
VH0464	O-RING, 011	1
VH0488	NUT, NYLOCK, 1/4 - 28	2
VH0489	SHCS, 1/4 - 28 x 1 1/2	2
VH0490	NUT, NYLOCK, 10 - 24	2
VH0491	BHCS, 10 - 24 x 1/2	4
VH0493	BRONZE SLEEVE BEARING	1
VH0494	RETAINING RING	1
VH0496	O-RING 030	1
VH0497	E-RING	1
VH0498	PIN, SLOTTED SPRING, 3/32 x 3/4	2
VH0499	PIN, DOWEL, 3/16 x 1/2	2
VH0500	PIN, SLOTTED SPRING, 1/8 x 11/16	3
VH0506	SPRING	1
VH0540	O-RING, #203	1
VH0623	BHCS, 8 - 32 x 1/4	1
VH0641	O-RING, #218	-
VH0662	PIN, SLOTTED, 1/16 x 7/16	1

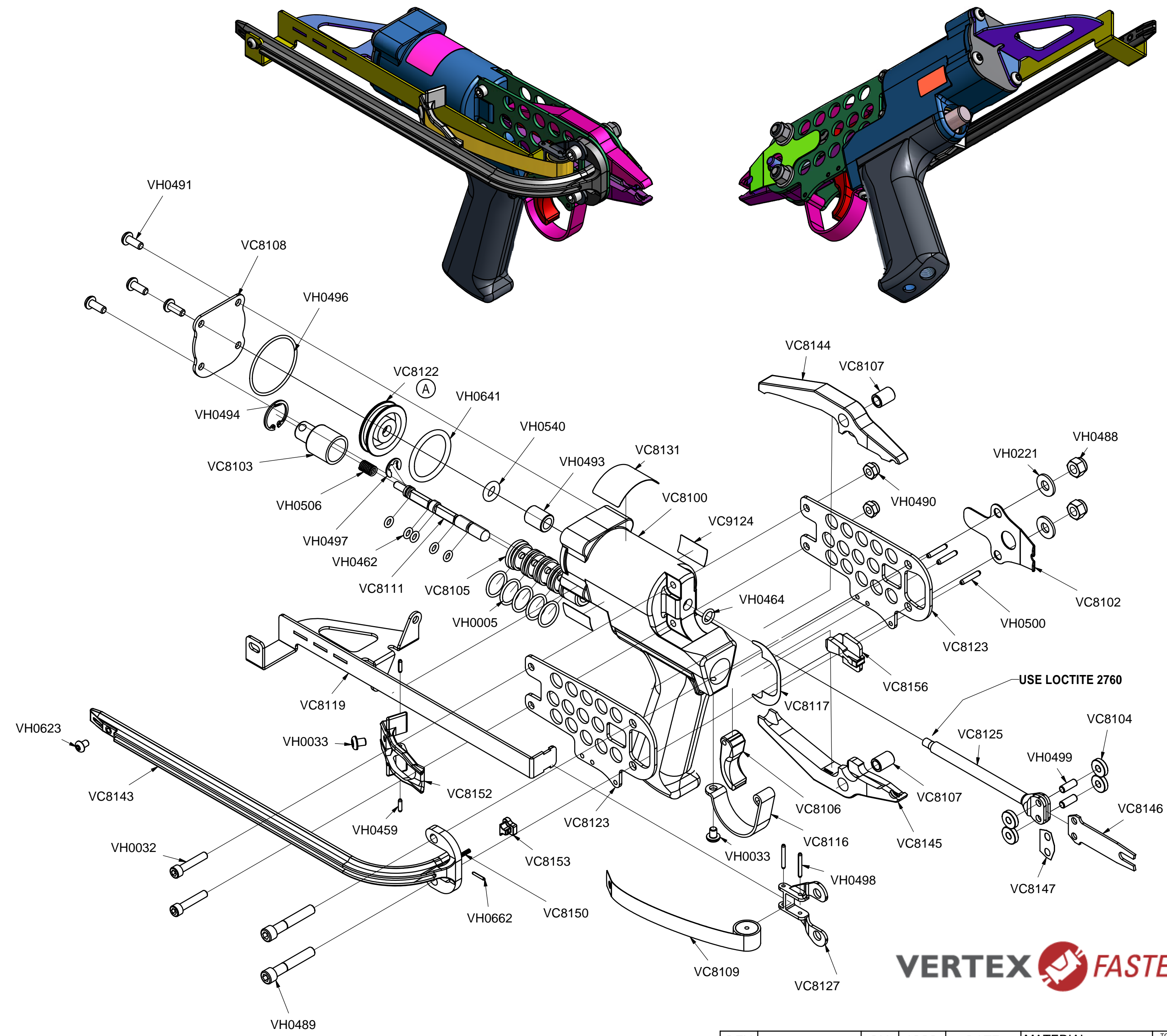

1798 Sherwin Avenue  
Des Plaines, IL 60018 U.S.A.  
EMAIL: vertex@leggett.com  
PHONE: 847-768-6139 FAX: 847-768-7192



REV	DESCRIPTION	BY	APPD	DATE	MATERIAL:	TOL. UNLESS SPECIFIED	© 2007	VERTEX FASTENERS INC.
A	ECN 782	JMW	MAR	5-24-07	HEAT TREATMENT:	INCHES .X = ± .030 .XX = ± .015 .XXX = ± .005 ANGLES ± 1/2°	DWN BY JMW	3714 JARVIS AVENUE SKOKIE, IL 60076 U.S.A.
					FINISH:		APPD MAR	1/2" C-RING TOOL ASSEMBLY
							DATE 3-27-07	
							SCALE	
							DWG. NO. VA0375	C

THIS DOCUMENT AND THE DATA DISCLOSED HEREIN OR HEREWITH IS NOT TO BE REPRODUCED, USED, OR DISCLOSED IN WHOLE OR IN PART TO ANYONE WITHOUT THE PERMISSION OF VERTEX FASTENERS INC.